

FORM NO 1.

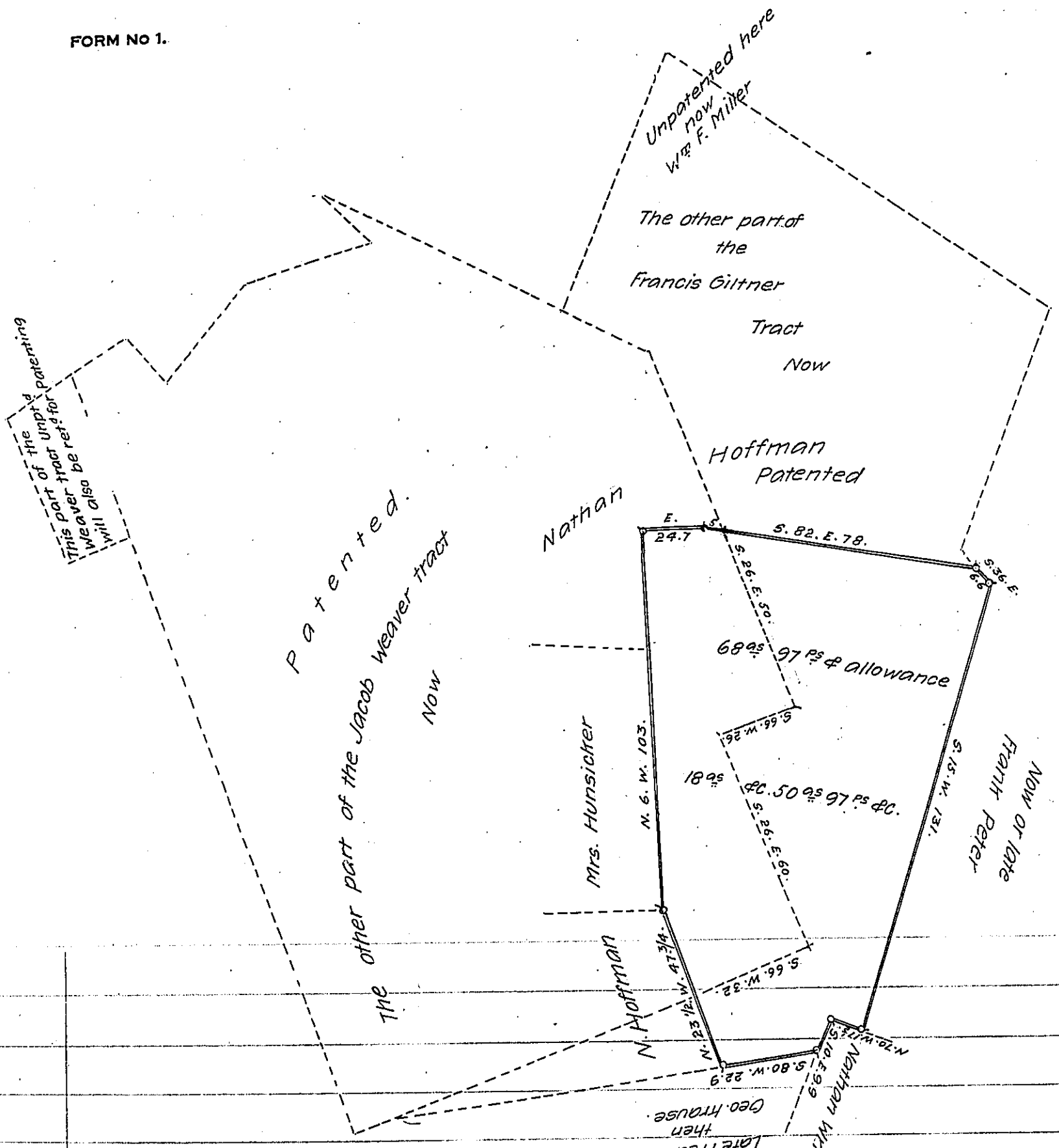

Draft of a tract of land situate in Heidelberg township,
 Lehigh County, containing 68⁰⁵ 97⁰⁵ and allowance of six per cent for roads &c. surveyed this 3rd day of Aug. 1873. for Peter Hoffman. It being parts of two larger tracts 18⁰⁵ & allowance being part of 171⁰⁵ 87⁰⁵ &c. Surveyed by Wt dated 2nd Nov. A.D. 1744 granted to Jacob Weaver, and 50⁰⁵ 97⁰⁵ & allowance being part of 109⁰⁵ &c. Surveyed by virtue of Appl. No. 1511. dated 21st May 1766 to Francis Giltner. The above to be embraced in one patent

Geo. Blant. C. S.

To R. B. Beath Esq.
 Surveyor General.

IN TESTIMONY that the above is a copy of the original remaining on file in the Department of Internal Affairs of Pennsylvania, made conformably to an Act of Assembly approved the 16th day of February, 1833, I have hereunto set my Hand and caused the Seal of said Department to be affixed at Harrisburg, this sixteenth day of July 1907.

Henry Houch
 Secretary of Internal Affairs.